

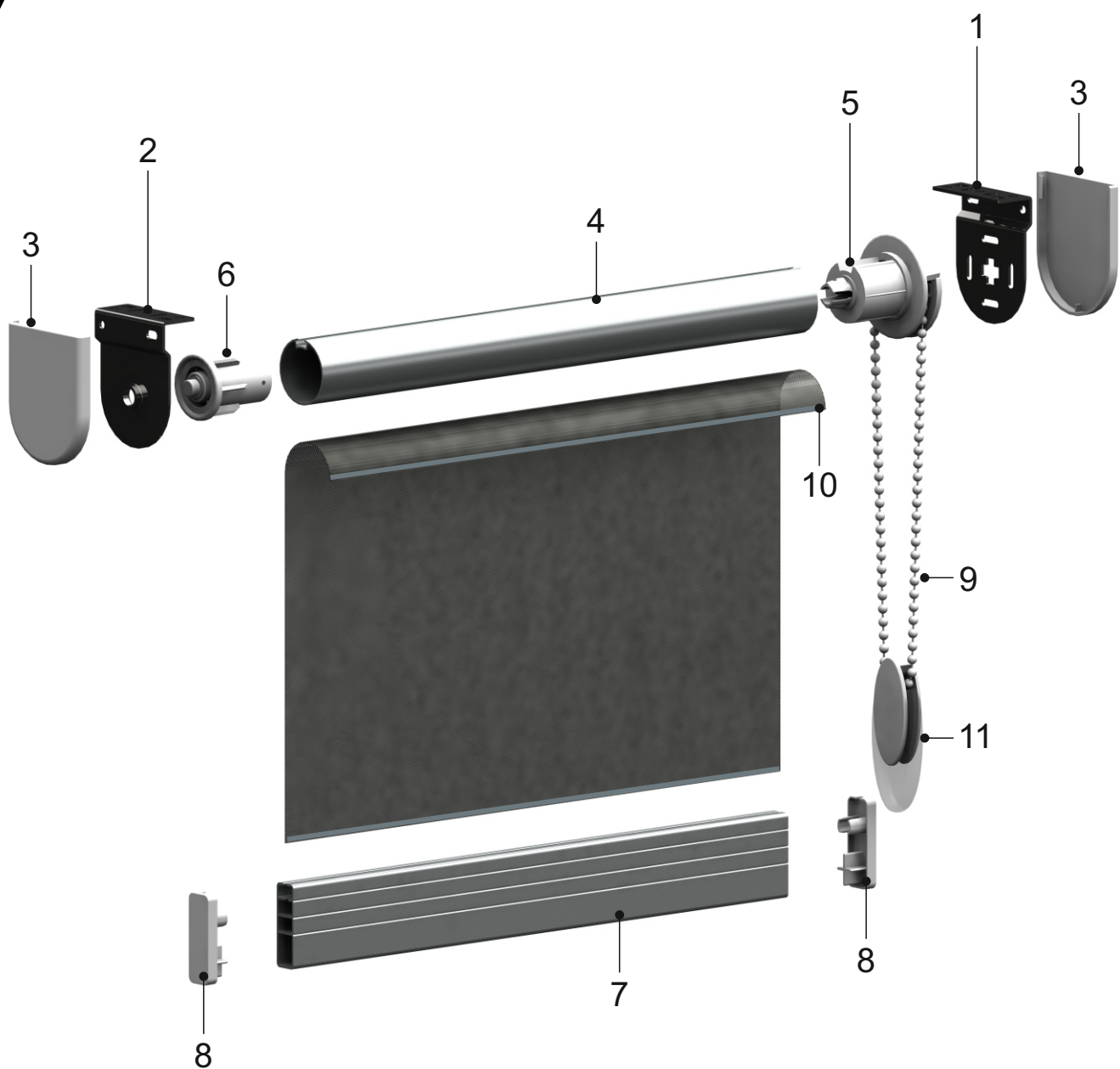









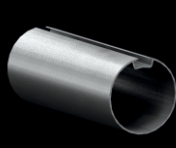

OPEN TYPE SYSTEMS

SYSTEM 60-T



- | | | | | | | | | | | | |
|---|--|---|--|---|---|----|---|----|---|---|---|
| 1 | 
BP766
Steel Side Bracket | 2 | 
BP767
Steel Side Bracket | 3 | 
BP768
Plastic Side Cover | 4 | 
BP041-03
Aluminium Tube 32 mm | 5 | 
BPÖ051
Mechanism 32 mm | 6 | 
BPÖ052
End Plug with Pin 32 mm |
| 7 | 
BP178
Aluminium Bottom Rail | 8 | 
BP177
End cap for Bottom Rail | 9 | 
BP020
Chain | 10 | 
BP043-03
Plastic Tape 9 mm | 11 | 
BP270-01
Chain Weight | | |

SYSTEM 60-T

TECHNICAL DETAILS

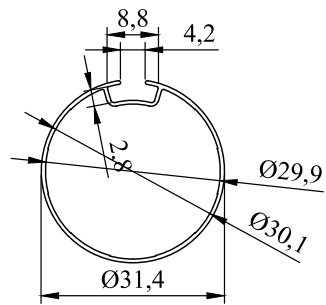

BP041-03

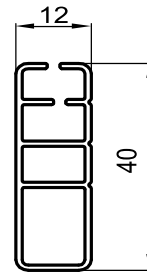

BP178