

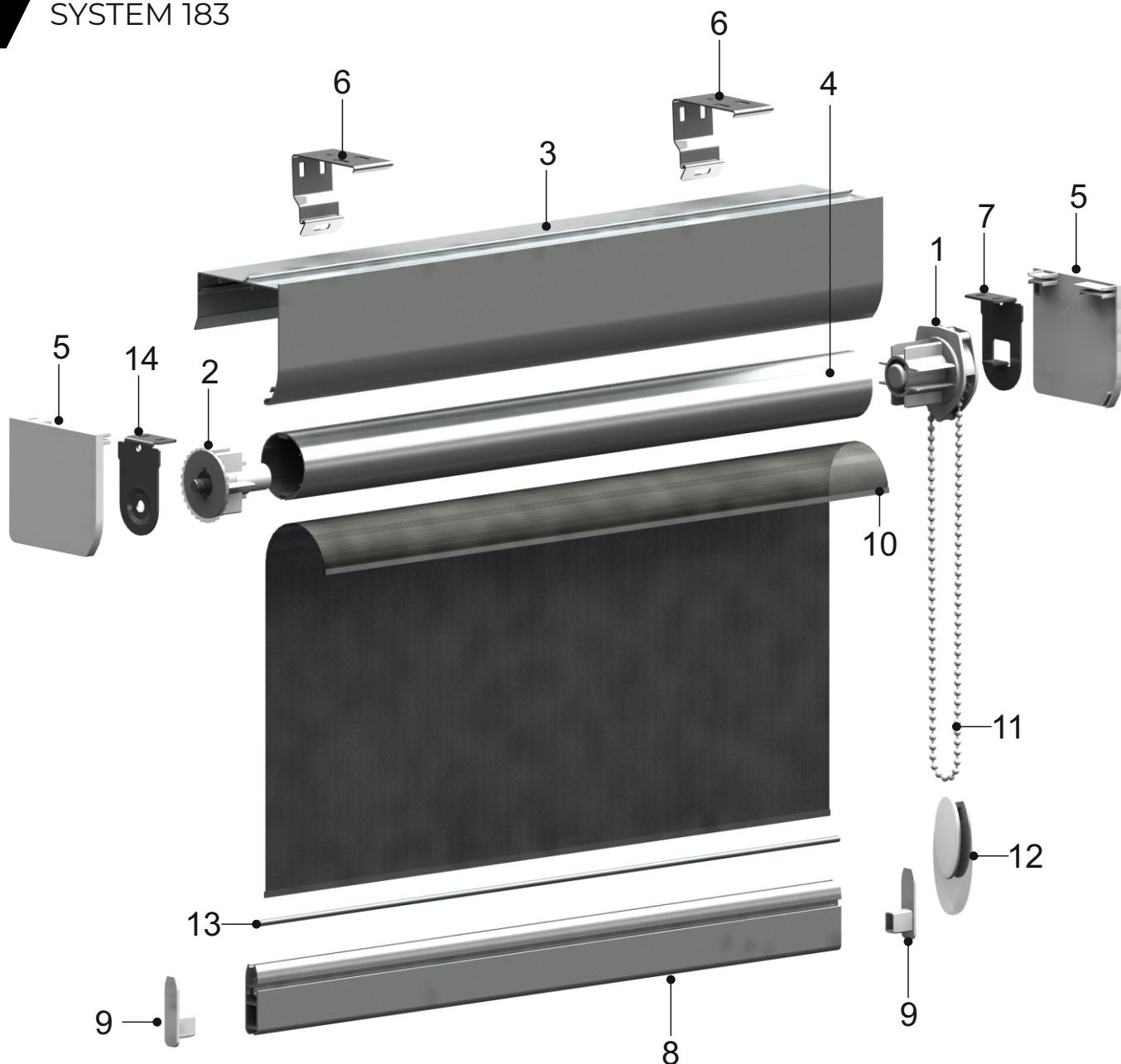









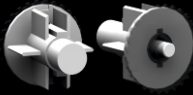
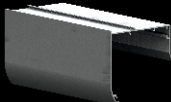

CLOSED TYPE SYSTEMS

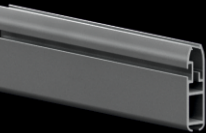
SYSTEM 183



- | | | | | | | |
|---|---|---|---|--|---|---|
|  |  |  |  |  |  |  |
| 1 BP410
Mechanism
43 mm | 2 BP449
End Plug
43 mm | 3 BP733
Aluminium
Cassette-Large | 4 BP388
Aluminium
Tube 43 mm | 5 BP734
End Cap
(L/R) | 6 BP735
L Shape
Steel Installation
Bracket | 7 BP309
Metal Side
Bracket
-Long |
|  |  |  |  |  |  |  |
| 8 BP815.M
Aluminium
Bottom Rail | 9 BP816
End cap for
Bottom Rail | 10 BP043-03
Plastic Tape
9 mm | 11 BP020
Chain | 12 BP270-01
Chain Weight | 13 BP044-02
Plastic Mil
Rod Ø4 | 14 BP310
Metal Side
Bracket
-Long |

SYSTEM 183

TECHNICAL DETAILS

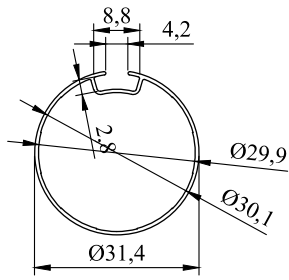

BP041-03

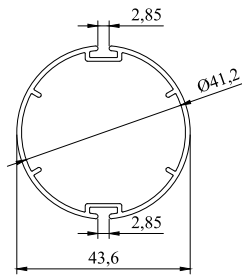

BP388

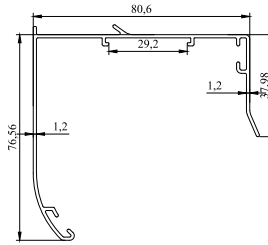

BP733

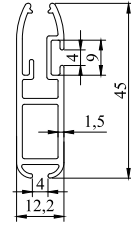

BP815.M

ALTERNATIVES



BP731

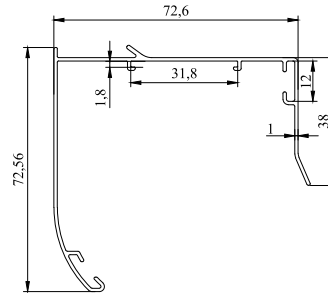

Aluminium Cassette - Small

option available